

Assessment of the red poultry mite infestation



Level 0

Condition of the surrounding

- Parasites are not spotted on the structural elements of the breeding halls (cages, feeders etc.)

Condition of birds

- The condition of the birds is very good
- The egg production is satisfactory
- The consumption of the fodder and the body weight of the birds is normal
- Complete and full plumage
- Correct colour of the cockscomb
- Lack of parasites

Response

PREVENTIVE APPLICATION

Level 1

- Single parasites can be spotted on the structural elements

- The consumption of the fodder and the egg production is normal
- The body weight of birds is correct
- Complete plumage
- Correct colour of the cockscomb
- Single parasites are spotted on the birds

PREVENTIVE TREATMENT

Level 2

- Small clusters of the parasites can be spotted on the structural elements

- Decrease of the egg production
- Increase in the fodder consumption
- Slight decrease in the body weight
- Irritability of the birds
- Visible partial feather loss
- Parasites are spotted on the birds

INTERVENTION TREATMENT REQUIRED

Level 3

- Many clusters of the parasites can be spotted on the structural elements
- Many clusters of the parasites can be spotted around the nests

- Significant decrease in egg production
- Significant increase in fodder consumption.
- Significant decrease in the body weight of the birds
- Incomplete plumage (skin is visible), pale cockscomb
- Weakening of the birds – birds begin to die
- Many parasites are spotted on the birds

IMMEDIATE TREATMENT REQUIRED



202102-3

How much product is needed to conduct the treatment?

Battery cage housing

One treatment consists of 2 applications (at 7 days interval) of 0.6% solution 100 ml/ m²

Calculate all sprayable surfaces: walls, floor and caging system

To get more accurate consumption estimation go to: dergall.com/calculator

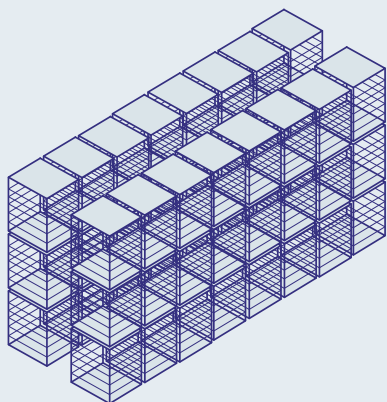

Example:

House: L: 60 m; w: 8 m; h: 7 m.
6 Rows of cages:
2 stacking 4;
2 stacking 5;
2 stacking 6.
1 row = 30 cages.
Nr. of birds: 40 000.

Product needed:
10 L Dergall to 1660 L of water = > 0,6% solution

Apply preventively once a month.
Apply a treatment any time the mite population peaks again.

Each house has its own particularities, it is recommended to consult your local distributor or veterinarian consultant for a personalized treatment.

How to apply Dergall®?

In order to achieve a satisfactory result of the treatment, the equipment used to conduct it should be chosen based on the size of the poultry house:

Garden, hand-operated or electric sprayer:

- flat stream nozzle with liquid usage of 0,8 - 1,2 L/ minute,
- pressure 0,3 - 0,5 MPa,
- very quiet while using.

It is recommended to be used in small poultry houses, or to spray places difficult to access in big farms.



Specialized pneumatic device:

- one-sided/two-sided, rotary, regulated pole 2.1 - 6.5 m high,
- liquid usage per nozzle: 0,8 - 1,2 L/ minute,
- the nozzles can be set in any kind of configuration,
- electric pump tank,
- quiet while using.



Efficacy and safety

in poultry mite control
in the poultry housing systems